

Montaje de base TopCase para Maleta Mastech



Nota:

No apriete todos los tornillos hasta que no estén completamente alineadas todas las perforaciones con respecto a los puntos de sujeción.

Antes de realizar la instalación, verifique todo el manual e identifique que las partes y las piezas estén completas.

Herramientas:

Kit llaves hexágonas

Kit llaves boca fija





Kit Instalado

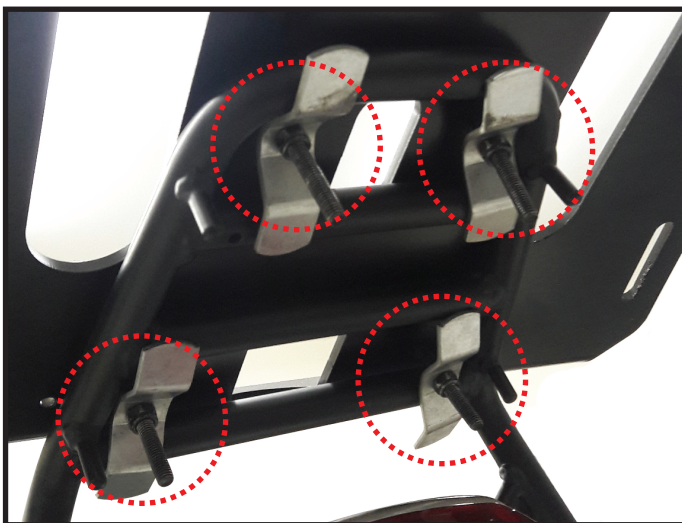

Instalación

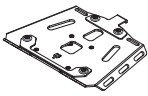
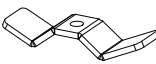
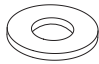

El Kit Contiene:

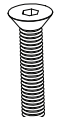
Base para maleta Top Case  Pla1 Cantidad: 1	Chapeta acero  Pla2 Cantidad: 4	Arandela plana M6 inox  Ara1 Cantidad: 4
Tuerca de seguridad M6  TC1 Cantidad: 4	Tornillo avellanado M6 x 35  T1 Cantidad: 4	

- 1- Instale la parrilla en la parte superior del herraje de la moto.
- 2- Ensamble la tornillería y chapetas como lo muestra el esquema.

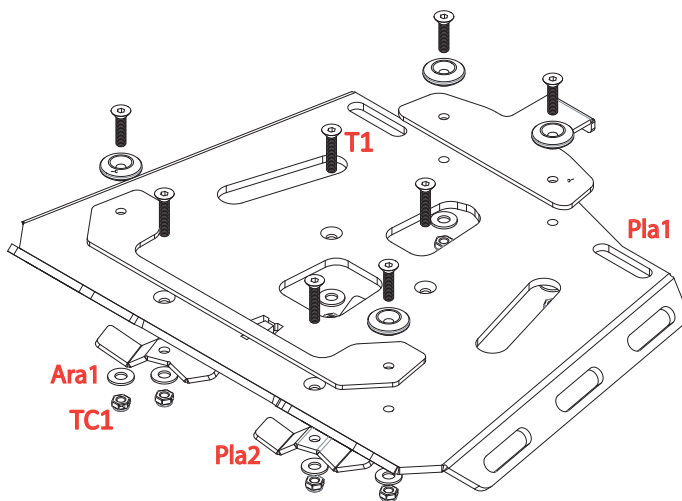

Al terminar la instalación de las partes, verifique que estén alineadas y que toda la tornillería esté debidamente apretada; reajuste todos los tornillos.



MASTECH

ROYAL ENFIELD HIMALAYAN 17/UP V2

Assembly Instructions top case rack for mastech pannier

Esp/Spa Ing/Eng

Note :

Do not tighten the screws until they are completely aligned with the holes.
Before the installation, please verify through the manual that all pieces and parts are complete.

Tools Required:

Hex Allen Wrench Set
Combination Wrench Set



Assembled Kit



Installation

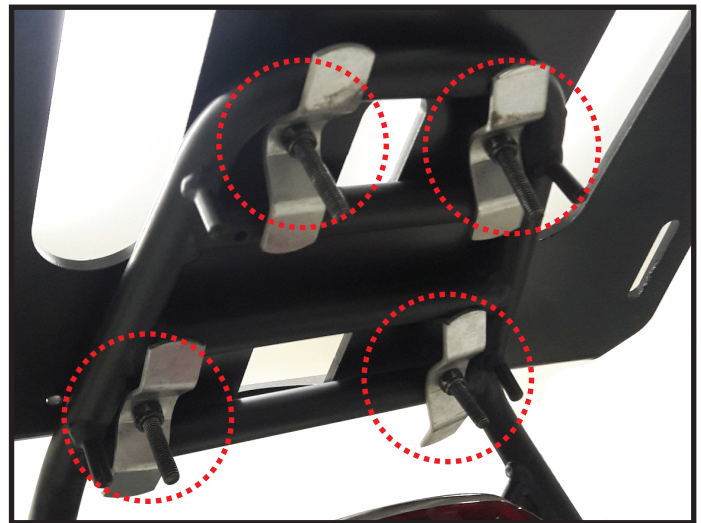

- 1- Install the pannier above the stock rack of the motorcycle.
- 2- Assemble the screws as shown in the picture.

Parts Included:

rac top case aluminum Pla1 Quantity: 1	steel plates Pla2 Quantity: 4	Flat washer M6 inox Was1 Cantidad: 4
Lock nut Nu1 Quantity: 4	countersunk bolt M6 X 35 B1 Quantity: 4	

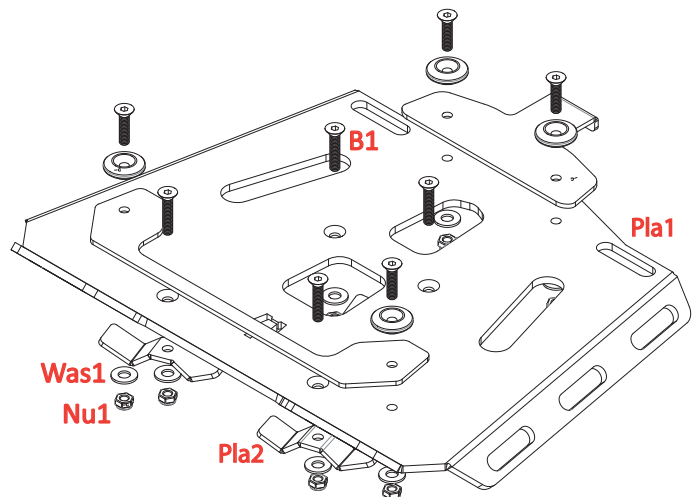

After the installation of the parts, please check that they are aligned and that all the hardware is properly tightened