

Montaje de base TopCase para Maleta Mastech



**Nota:**

No apriete todos los tornillos hasta que no estén completamente alineadas todas las perforaciones con respecto a los puntos de sujeción.

Antes de realizar la instalación, verifique todo el manual e identifique que las partes y las piezas estén completas.

**Herramientas:**

- Kit llaves hexágonas
- Kit llaves boca fija

## Kit Instalado



## Instalación



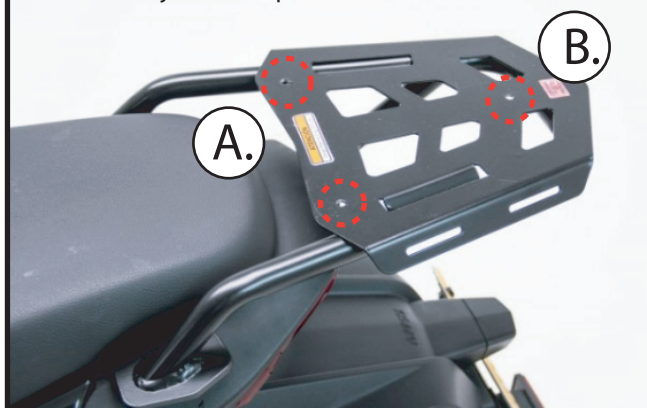

Puntos de sujeción Fireparts

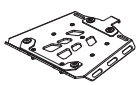

Use TM1 para sujetar PLA1 a punto de anclaje A. y TM2 para punto de anclaje B.

Nota: Para el anclaje de la base top case MASTECH en parrillas de otras marcas utiliza PLA2.

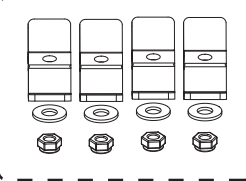
## El kit contiene

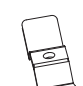
<p>Platina base top case</p>  <p><b>PLA1</b></p> <p>Cantidad: 1</p>	<p>Tornillo Avellanado M6 x 25 inox</p>  <p><b>TM1</b></p> <p>Cantidad: 7</p>	 <p>Platinas adicionales puntos de sujeción alternos a Fireparts</p>
<p>Tuerca de seguridad M6</p>  <p><b>TCA1</b></p> <p>Cantidad: 7</p>	<p>Arandela M6 inox</p>  <p><b>ARA1</b></p> <p>Cantidad: 7</p>	
<p>Platina anclaje inferior</p>  <p><b>PLA2</b></p> <p>Cantidad: 7</p>		

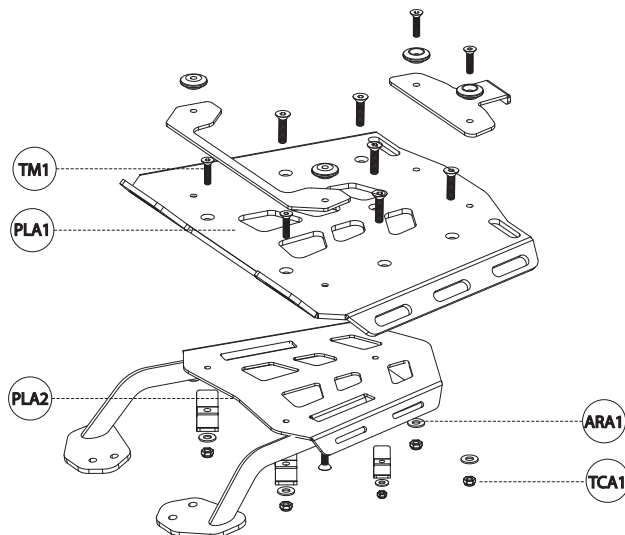

Al terminar la instalación de las partes, verifique que estén alineadas y que toda la tornillería esté debidamente apretada; reajuste todos los tornillos.

Assembly Instructions top case rack for mastech pannier



**Note :**

Do not tighten the screws until they are completely aligned with the holes.  
Before the installation, please verify through the manual that all pieces and parts are complete.

**Tools Required:**

Hex Allen Wrench Set  
Combination Wrench Set

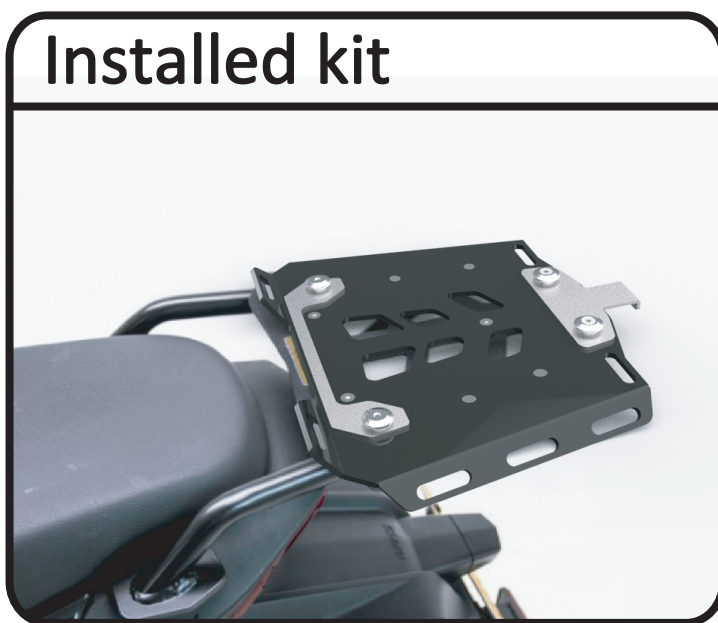



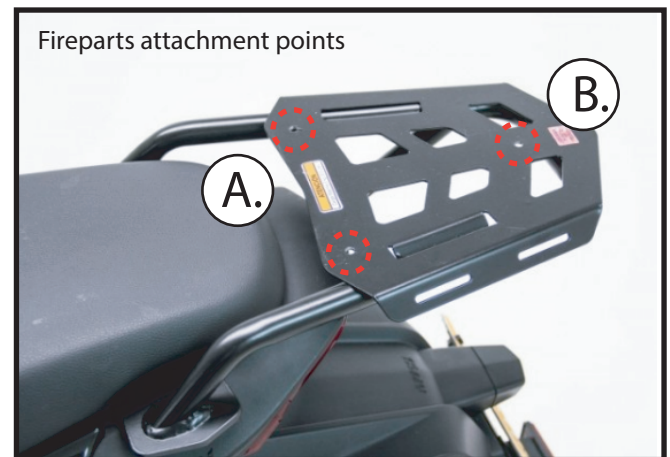



## Installation

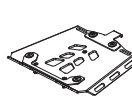

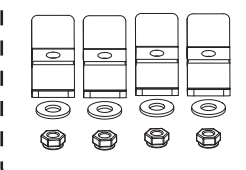
Use TM1 to attach PLA1 to anchor point A. and TM2 to anchor point B.  
Note: For the anchoring of the MASTECH top case base on grills of other brands use PLA2.

## Parts included

<p>Top case base plate</p>  <p><b>PLA1</b></p> <p>Quantity: 1</p>	<p>Countersunk screw M6 x 25 inox</p>  <p><b>TM1</b></p> <p>Quantity: 7</p>	 <p>Additional decks alternate attachment points to Fireparts</p>
<p>Safety nut M6</p>  <p><b>TCA1</b></p> <p>Quantity: 7</p>	<p>Washer M6</p>  <p><b>ARA1</b></p> <p>Quantity: 7</p>	
		<p>Bottom anchor plate</p>  <p><b>PLA2</b></p> <p>Quantity: 7</p>

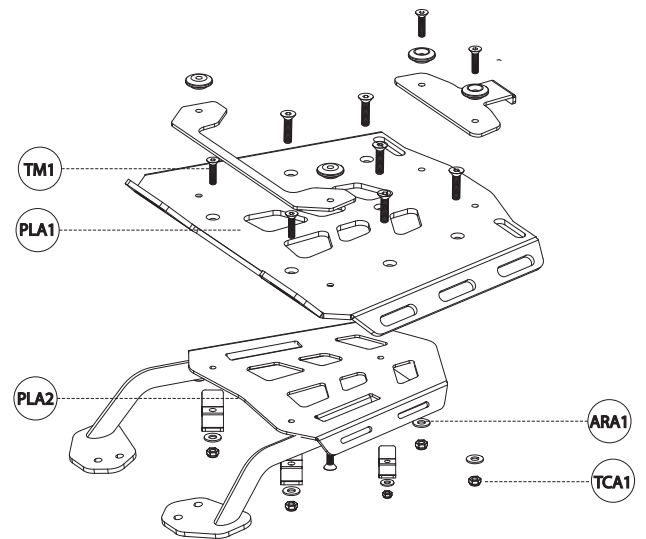

After the installation of the parts, please check that they are aligned and that all the hardware is properly tightened